



Tab Lock System Installation Instructions

AtlasMasland's TAB LOCK System is designed for installing our modular tiles over many different substrates, especially when adhesive is not practical or preferred. The 3" x 3" carpet tile tabs have a 3/4" strip of adhesive on the back which can be peeled and stuck into position or left covered to create a floating type installation.

LAYOUT AND INSTALLATION

Layouts differ and the following recommendations are for common rectangular areas. When possible, strike a chalk line parallel to an outside wall near the center of the room. Strike another chalk line at right angles to the first line, also near the center of the room. The exact location of these lines is governed by the room size. Plan your layout to leave at least half of a full tile around the perimeter. Where the two chalk lines intersect is the intended installation starting point. It is important to firmly secure the first dozen or so tiles with TAB LOCKS before panning out in different directions. Continue placing the TABS at every joint of the tiles throughout the entire installation. Smaller fill pieces may require a TAB in the middle to better anchor them to the adjacent tiles. As you progress with the installation, we recommend rolling the tiles with a 50 to 75 lb. roller in both directions.

Many of AtlasMasland's running line carpet tiles are better suited for the quarter turn installation method. Should other types of installation be desired (Ashlar, Modified Ashlar, etc.), AtlasMasland recommends installing a mock up area for aesthetic approval.

FOR QUARTER TURN / MONOLITHIC / NON DIRECTIONAL INSTALLATION

A TAB LOCK should be placed under every corner of each tile across the installation area and all cut tiles adjacent to the field tiles.

FOR BRICK OR ASHLAR INSTALLATION METHODS

A TAB LOCK should be placed on every other corner across the installation area and all cut tiles adjacent to the field tiles.

TAB LOCK should be applied based on the following diagrams.

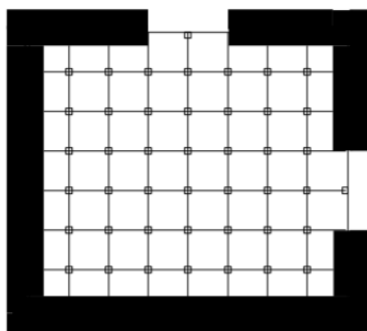

Quarter-Turn / Monolithic / Non-Directional

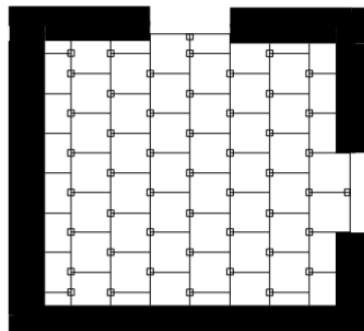

Brick or Ashlar

PRE-INSTALLATION CHECKLIST

Locate the tiles on site at least 24 hours prior to installation.

Check the box label containing important information such as style, color, dye lot # and quantity.

Look for concealed damage, manufacturing defects and shipping errors.

Read this bulletin and other applicable literature pertaining to the installation of AtlasMasland carpet tile.

WARRANTIES

AtlasMasland Contract specifically excludes claims involving carpet tiles installed with visible defects. Should other trades perform work in areas where AtlasMasland carpet tiles have been installed, the installer and / or general contractor assumes total liability for damage and deterioration including wear, compaction, soiling, staining and abrasion. Failure to provide adequate protection until occupancy may void all AtlasMasland Contract Warranties.

Job Site Conditions

TEMPERATURE: Air and subfloor minimum 65 degrees Fahrenheit, 48 to 72 hours prior to, during, and after installation.

pH: Sub floor readings should be between 7.0 – 9.0. If the pH is outside these parameters contact the General Contractor to correct the condition.

RELATIVE HUMIDITY: Between 12 % and 65 % for 24 hours prior to installation.

CONCRETE: Should be allowed to cure for 90 to 120 days. Concrete sub floors must be tested for moisture emissions prior to installing AtlasMasland carpet tile.

RELATIVE HUMIDITY IN SUBSTRATE: Determined by the ASTM-F-2170-09 Relative Humidity in situ Probe Test should not exceed 85%.

SUBFLOOR: Should be sound and free of oil, grease, paint, and any other foreign substance that may inhibit adhesion. Surfaces must be smooth and level before installing AtlasMasland carpet tile.

PATCH AND LEVELERS: Cracks and unlevelled subfloors should be corrected with approved latex fortified Portland cement based patch, or leveling compound, such as Armstrong S-180, Ardex Feather Finish, or Mapei Planipatch.

OLD ADHESIVES: Pressure Sensitive: Scrape any existing trowel notches completely level and prime with AtlasMasland's Encapsulate Primer.

MULTI-PURPOSE: Scrape existing trowel notches completely level and prime the surface with AtlasMasland's Encapsulate Primer.

SWEEPING: Sweep or vacuum the entire area before applying adhesive. Do not use sweeping compounds; they often contain oily residues which can inhibit the adhesive bond.

COVERAGE: TAB LOCK Tabs: 500 per roll covers approx. 130 square yards.
AtlasMasland's Encapsulate Primer covers approximately 160 square yards per 4-gallon pail.

TRANSITION AND TERMINATING AREAS: All tile must be installed flush or level with the surrounding hard surfaces. Carpets protruding above the hard surfaces create a partially unprotected edge and will not perform as specified. Terminating edges must be protected by edge moldings (see CRI 104.) Damaged tile at transition or terminating areas is not a manufacturing defect.

POST INSTALLATION Luan, Masonite or Heavy Kraft paper may be used as post installation protection. Regardless of installation method do not use plastic, self-adhering membranes or any other type of impermeable products. These products can leave adhesive residue on the carpet fiber and will attract soiling and possibly cause discoloration.
USE OF THESE PRODUCTS WILL VOID ALL WARRANTIES.

For specific questions or installation instructions not addressed in this bulletin contact **AtlasMasland Technical Services:**
1-800-633-0468